

Pinewood



ENERGY WISE HOMES

OVERALL DIMENSIONS

24'-0" x 48'-0"

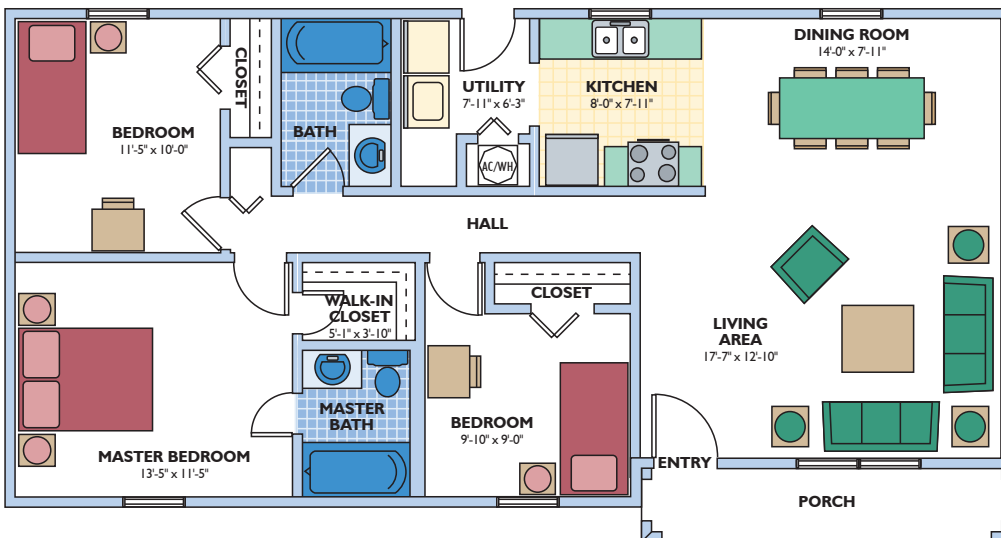
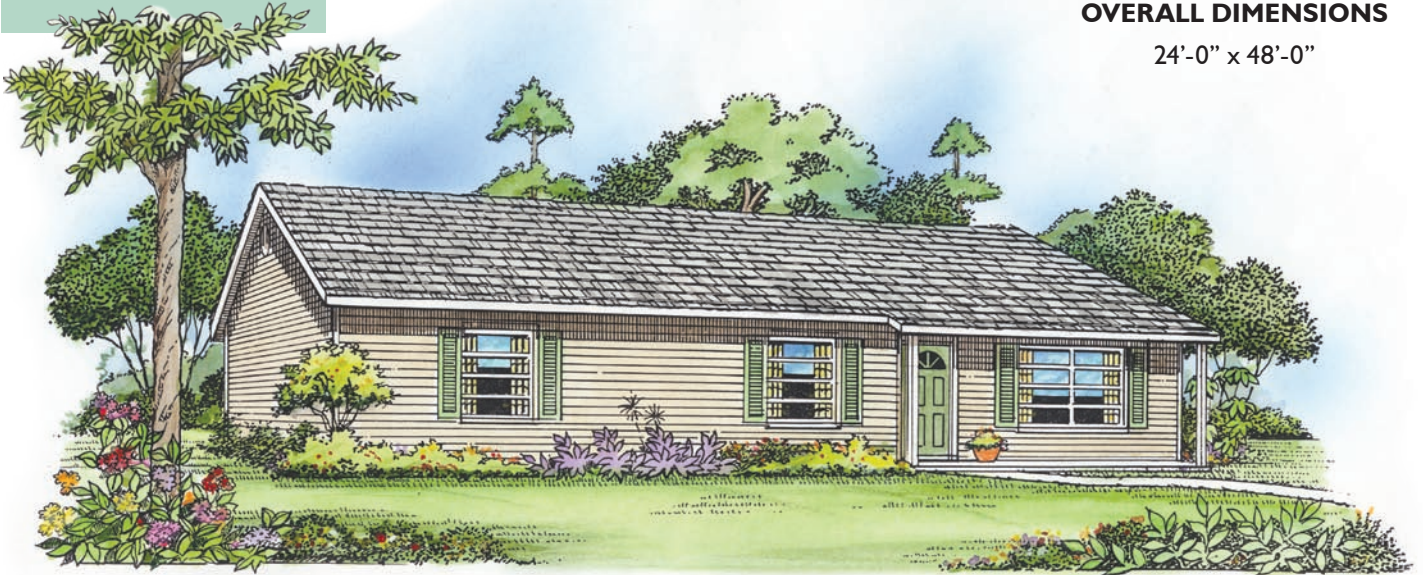

Structall offers a complete line of precut and preengineered home and building packages utilizing structural insulated panel technology (SIPs). All packages erect quickly, are stronger than conventional framing and extremely energy efficient. SIPs can be clad in conventional OSB or in steel incorporating the patented Snap-N-Lock panel connection.

Snap-N-Lock™ Insulated Panel

Your Choice of Aluminum or Steel Skins

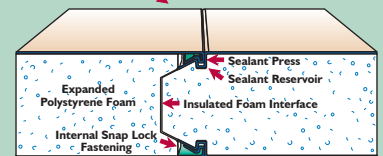

Patent No.'s 4,769,963 and 5,086,599

Metal Chemically Bonded to Foam

Dual Plywood Spline Joint

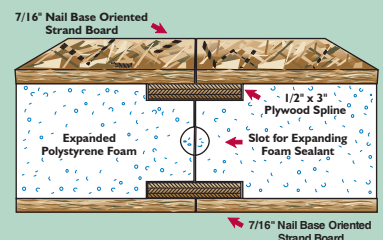

You won't find any wasted space in this ranch style home. The living area is of ample size, and the adjacent dining room gives the appearance of having even more space. All three bedrooms are a comfortable size as well. The kitchen is tucked away from the entry view, and the utility room is definitely an added plus.

Living Area 1,116 sq.ft.
front cov. porch 54 sq.ft.
TOTAL 1,170 sq.ft.
 3 bedroom, 2 bath



Plans and specifications are subject to change without notice. All dimensions are approximate.